

Shuttle Accessory POR01 Serial Port Adapter for POS01

The Shuttle All-in-One PC of the X50 and P90U series [1] can be equipped with the optional accessory POS01, which is an extension kit with four serial ports (2x D-Sub and 2x RJ45), one parallel port and an RJ11 DIO port for cash drawers. With the help of the adapter cable POR01, the RJ45 ports can be converted to the 9-pin D-Sub standard, which is the traditional connector for serial devices.

[1] this includes the following models: X50V4, X50V5, X50V5U3, X50V6, X50V6U3, X50V7, X50V7U3, P90U, P90U3, P90U5

Specification

Scope of delivery	- Adapter cable - This specification
Connector 1	RJ45, 8-pin, shielded
Connector 2	D-Sub, 9-pin, male
Length	ca. 70 cm
Order number	POA-POR01

Shuttle Accessory POR01



Accessory POR01



RJ45 connector



9-pin D-Sub connector

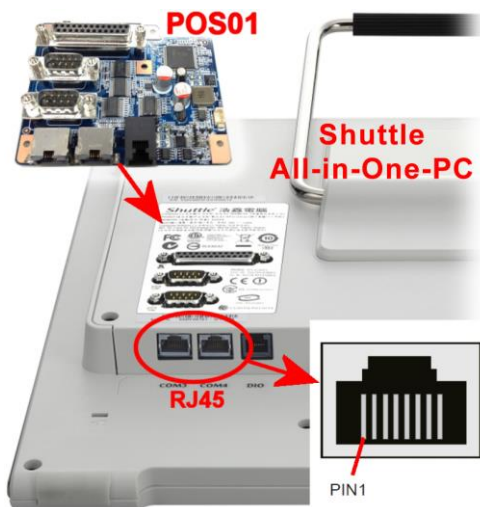

POS01 pin assignment of COM3/COM4 port with RJ45 output connector:

Pin	Signal name
1	RxD Transmit Data
2	TxD Transmit Data
3	DSR Data Set Ready
4	DTR Data Terminal Ready
5	RTS Request to Send
6	DCD Data Carrier Detect
7	CTS Clear to Send
8	RI Ring Indicator
Shield	GND Ground

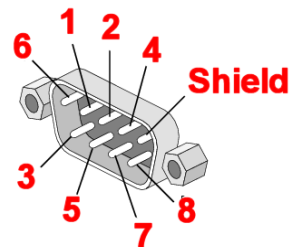

Pin assignment of the 9-pin D-Sub connector

© 2020 by Shuttle Computer Handels GmbH (Germany). All information subject to change without notice. Pictures for illustration purposes only.

